



SPECIFICATIONS

9000 SERIES NIGHT COVER

RETROFIT CASSETTE

ITEM #s:

- | | |
|------------------------------|---|
| 91104 4ft Night Cover | 91104-01 4ft Night Cover
<i>Winter 2017</i> |
| 91106 6ft Night Cover | 91106-01 6ft Night Cover
<i>Spring 2017</i> |
| 91108 8ft Night Cover | 91108-01 8ft Night Cover
<i>Spring 2017</i> |



SPECIFICATIONS

- Model Type: Retrofit Cassette
- Fabric Type: Woven Aluminum laminated to Polyethersulfone, Perforated; Sealed with Polyethylene. Laser Sealed Edges; Exceeds UL94HB Fire Retardent Standard
- Anti-Bacterial: Engineered Solution
- Fabric Length: 78"
- Handle: Clip-on Slim-Line Handle
- Secures with: 2 x clip-on magnets on the bottom rail profile
- Sizes: 4ft, 6ft, 8ft (width)
- Housing: Recyclable Extruded Aluminum Cassette Cover
- Mounting System: Permanent two-piece glass reinforced plastic mounting system with male/female brackets
- Braking System: Smooth, Controlled Retraction using Hydraulic Spring/Brake Assembly
- Retension: Factory Preset Tension - Easy Adjustment -
- Bottom Rail Profile: Recyclable Heavy Gauge Extruded Aluminum (30mm)
- Optional: (1) Hook (for handle) in lieu of magnets, (2) Clip-on Hooks for horizontal coffin cases

INCLUDED

OPTIONAL



Handle



2 x Secure Snap
Clip-On Magnets



End Cap &
Mounting Bracket



Night Covers w/ new
End Cap coming
Spring 2017

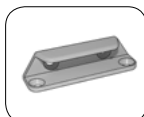

Hook for Handle

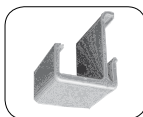

Clip-on Hook